

# B AC Motors

S.C. Reversible Motor 6W (□70mm)

## 6W Speed Control Reversible Motor 6W(□70mm)

### Motor Specification

| Model<br>7SRDG□-6G: Gear Type Shaft<br>7SRDD□-6: D-Cut Type Shaft | Output<br>W | Voltage<br>V | Frequency<br>Hz | Poles | Duty   | Speed Range<br>r/min | Starting Torque |       | Permissible Torque |       |         |       | Capacitor<br>μF / VAC |
|---|-------------|--------------|-----------------|-------|--------|----------------------|-----------------|-------|--------------------|-------|---------|-------|-----------------------|
|   |             |              |                 |       |        |                      | kgfcm           | N.m   | 1200r/min          |       | 90r/min |       |                       |
|   |             |              |                 |       |        |                      |                 |       | kgfcm              | N.m   | kgfcm   | N.m   |                       |
| 7SRDGA-6G   | 6           | 1φ110        | 60              | 4     | 30min. | 90-1700              | 0.50            | 0.050 | 0.58               | 0.058 | 0.43    | 0.043 | 3.0 / 250             |
| 7SRDGD-6G   | 6           | 1φ220        | 60              | 4     | 30min. | 90-1700              | 0.51            | 0.051 | 0.56               | 0.056 | 0.42    | 0.042 | 1.0 / 450             |
| 7SRDGE-6G   | 6           | 1φ220        | 50              | 4     | 30min. | 90-1400              | 0.35            | 0.035 | 0.35               | 0.035 | 0.22    | 0.022 | 0.8 / 450             |
|   |             | 1φ240        |                 |       |        |                      | 0.42            | 0.042 | 0.45               | 0.045 | 0.22    | 0.022 |                       |

- 1) Enter the phase & voltage code in the in the box (□) within the motor model name.
- 2) All models contain a built-in thermal protector.
- 3) Gear Type Shaft are for attaching Gearbox and D-Cut Type Shaft are for using motor only.

### Max. Permissible Torque at Output Shaft of Gearbox

| Motor Model | Gearbox Model | r/min | V       | Hz   | Gear Ratio | 3    | 3.6  | 6    | 7.5  | 9    | 12.5 | 15   | 18   | 25   | 30   | 36   | 50   | 60   | 75   | 90   | 100  | 120  | 150  | 180  |      |
|-------------|---------------|-------|---------|------|------------|------|------|------|------|------|------|------|------|------|------|------|------|------|------|------|------|------|------|------|------|
| 7SRDG□-6G   | 7GBK□BMH      | 1200  | 110     | 60   | kgfcm      | 1.4  | 1.7  | 2.9  | 3.6  | 4.3  | 6.0  | 7.2  | 8.7  | 10.9 | 13.1 | 14.2 | 19.7 | 23.7 | 29.6 | 35.5 | 39.4 | 47.3 | 50.0 | 50.0 |      |
|             |               |       |         |      | N.m        | 0.14 | 0.17 | 0.28 | 0.35 | 0.42 | 0.59 | 0.71 | 0.85 | 1.07 | 1.28 | 1.39 | 1.93 | 2.32 | 2.90 | 3.48 | 3.87 | 4.64 | 4.90 | 4.90 | 4.90 |
|             |               |       | 220/240 | 50   | kgfcm      | 1.1  | 1.3  | 2.2  | 2.8  | 3.4  | 4.7  | 5.6  | 6.7  | 8.4  | 10.1 | 11.0 | 15.3 | 18.4 | 23.0 | 27.5 | 30.6 | 36.7 | 45.9 | 50.0 | 50.0 |
|             |               | N.m   | 0.11    | 0.13 | 0.22       | 0.27 | 0.33 | 0.46 | 0.55 | 0.66 | 0.83 | 0.99 | 1.08 | 1.50 | 1.80 | 2.25 | 2.70 | 3.00 | 3.60 | 4.50 | 4.90 | 4.90 | 4.90 |      |      |
|             |               | 90    | 110     | 60   | kgfcm      | 1.1  | 1.3  | 2.1  | 2.7  | 3.2  | 4.5  | 5.4  | 6.4  | 8.1  | 9.7  | 10.5 | 14.6 | 17.5 | 21.9 | 26.3 | 29.2 | 35.1 | 43.9 | 50.0 | 50.0 |
|             |               |       |         |      | N.m        | 0.10 | 0.13 | 0.21 | 0.26 | 0.31 | 0.44 | 0.52 | 0.63 | 0.79 | 0.95 | 1.03 | 1.43 | 1.72 | 2.15 | 2.58 | 2.87 | 3.44 | 4.30 | 4.90 |      |
| 220/240     | 50            |       | kgfcm   | 0.5  | 0.7        | 1.1  | 1.4  | 1.6  | 2.3  | 2.7  | 3.3  | 4.1  | 5.0  | 5.4  | 7.5  | 9.0  | 11.2 | 13.5 | 15.0 | 18.0 | 22.4 | 26.9 | 26.9 |      |      |
| N.m         | 0.05          | 0.06  | 0.11    | 0.13 | 0.16       | 0.22 | 0.27 | 0.32 | 0.40 | 0.49 | 0.53 | 0.73 | 0.88 | 1.10 | 1.32 | 1.47 | 1.76 | 2.20 | 2.64 | 2.64 | 2.64 |      |      |      |      |

- 1) Enter the phase & voltage code in the box (□) within the motor model name.
- 2) Enter the gear ratio in the box (□) within the Gearbox model name.
- 3) A colored background indicates gear shaft rotation in the same direction as the motor shaft; a white background indicates rotation in the opposite direction.
- 4) The rotating speed is calculated by dividing the motor's synchronous speed (50Hz: 1,500r/min, 60Hz: 1,800r/min) by the gear ratio.  
The actual speed is 2~20% less than the displayed value, depending on the size of the load.

### Dimensions

#### MOTOR ONLY

● MOTOR MODEL: 7SRDD□-6 (NO FAN)

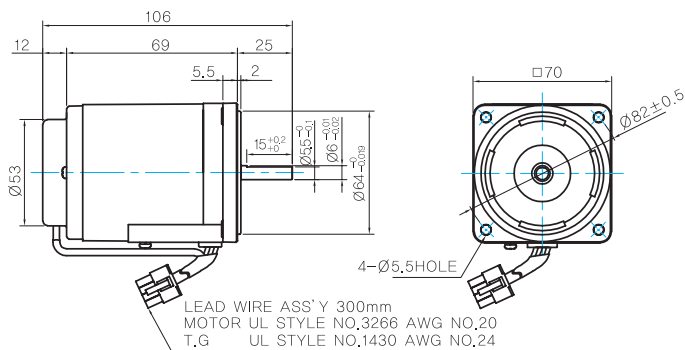

#### MOTOR OUTPUT SHAFT

| MODEL      | SPEC   |
|------------|--|
| D-CUT TYPE | <p>Technical drawing of the motor output shaft showing dimensions: 25 (shaft length), 15 (shaft diameter), 15.5 (shaft diameter), 16 (shaft diameter), 16.5 (shaft diameter), 17 (shaft diameter), 17.5 (shaft diameter), 18 (shaft diameter), 18.5 (shaft diameter), 19 (shaft diameter), 19.5 (shaft diameter), 20 (shaft diameter), 20.5 (shaft diameter), 21 (shaft diameter), 21.5 (shaft diameter), 22 (shaft diameter), 22.5 (shaft diameter), 23 (shaft diameter), 23.5 (shaft diameter), 24 (shaft diameter), 24.5 (shaft diameter), 25 (shaft diameter).</p> |

## GEARED MOTOR

### G TYPE GEARBOX

- MOTOR MODEL:  
7SRDG□-6G (NO FAN)

- GEARBOX MODEL:  
7GBK□BMH

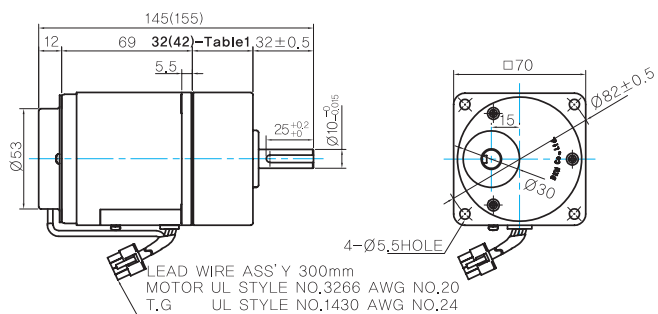

### GEARBOX OUTPUT SHAFT

| MODEL    | SPEC |
|----------|------|
| KEY TYPE |      |

### KEY SPEC

| GEARBOX |  |
|---------|--|
|         |  |

### WEIGHT

| PART     |                           | WEIGHT(Kg) |
|----------|---------------------------|------------|
| MOTOR    |                           | 0,93       |
| GEAR BOX | 7GBK3BMH<br>- 7GBK18BMH   | 0,36       |
|          | 7GBK25BMH<br>- 7GBK30BMH  | 0,44       |
|          | 7GBK36BMH<br>- 7GBK180BMH | 0,5        |

### 32(42)-Table1

| SIZE(mm) | GEAR RATIO             |
|----------|------------------------|
| 32       | 7GBK3BMH - 7GBK18BMH   |
| 42       | 7GBK25BMH - 7GBK180BMH |

## Motor Images

